

Greengate Release

The Crawford



\$258,500

Building Area: 149.5m² Lot Size: Approx 257m²

Lot 147

If open plan living and contemporary style is your kind of thing, you'll fall hard for The Crawford. Complete with 3 bedrooms (including built-in robes) and a main bathroom upstairs, plus an outdoor alfresco area under the main roof – this is one sensational pad. A single garage, extra off-street parking, a fully landscaped front yard and bonus solar gas-boosted hot water system top it off. Enjoying the close proximity to the walking and cycling trails of the newly landscaped Smith Creek Reserve, one look is sure to have you hooked.

Features

- Single car garage with additional off-street car parking
- Light filled, open plan entertaining/living area
- Downstairs powder room
- Spacious upstairs retreat with 3 bedrooms and main bathroom
- Built-in robes to all bedrooms
- Fully landscaped front yard and bonus solar gas-boosted hot water system

Ground Floor

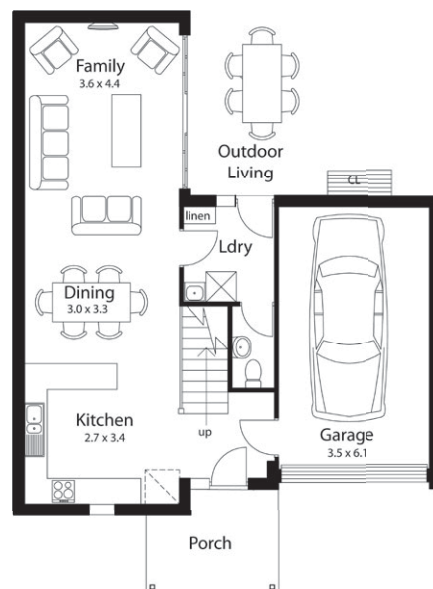

First Floor



Government of
South Australia

www.playfordalive.com.au

Greengate Release

The Crawford



If the chance to live in a secluded haven is at the top of your list, your wish is about to be granted. Introducing the Greengate Release where great location and affordability go hand in hand.

Set within the convenience of Smithfield Plains, you'll share your piece of paradise with just 5 neighbours. Featuring a public green space and serviced by 2 private laneways, the Greengate Release is nestled adjacent to the newly landscaped Smith Creek Reserve. Walking and cycling trails lie just outside your door, so this is one address that's sure to stake its claim on your heart.

With 6 homes to choose from based on 3 contemporary, to-die-for designs, the Greengate Release is certain to create quite a stir. Affordable housing simply doesn't get better than this.

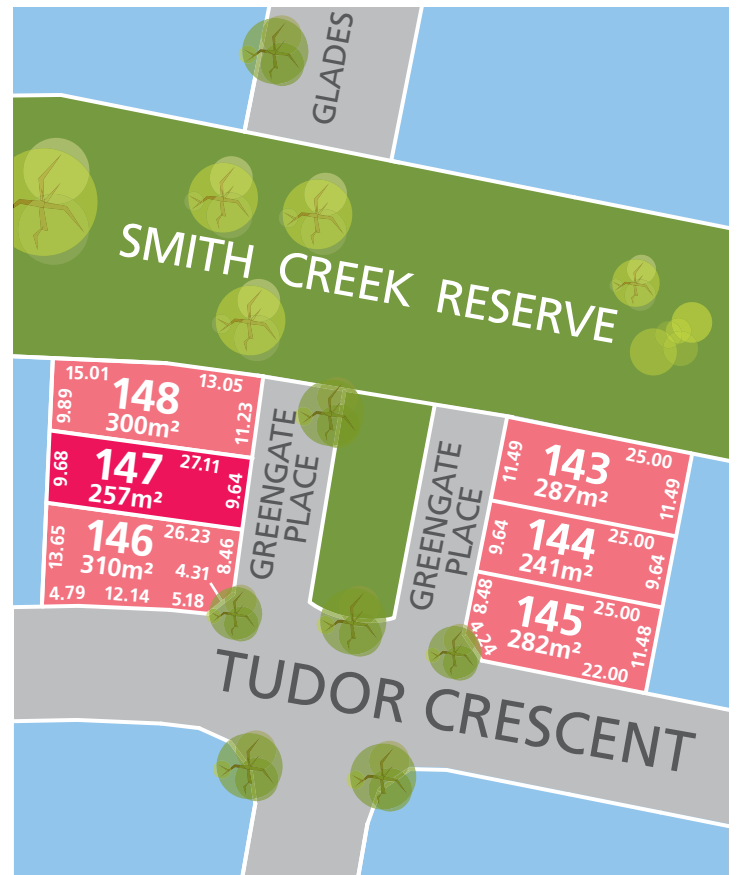

USE THIS KEY TO UNLOCK YOUR VERY OWN HOME



When you see a home with this key icon, it signals that it is part of Housing SA's Affordable Homes Program. The property is for sale to "eligible" buyers for a limited period of time at a fixed price. Check your eligibility at affordablehomes.sa.gov.au



*Whilst all care has been taken in the preparation of this material, no responsibility is taken for errors or omissions and details may be subject to change. Intending purchasers should not rely on statements or representations and are advised to make their own enquiries to satisfy themselves in all respects. Artwork images and plans are impressions only and are not to be relied upon as a definitive reference. The Playford Alive development intends by this statement to exclude liability for all information contained herein. 7723_1211